

## LT-3000 2x8 Synchronous Fiber Optic Switch

Model Number: N208XMDE-SCU

Item	Unit	Specifications
Wavelength Range	nm	1310 & 1550 dual window
Insertion Loss without Connectors	dB	< 1.0
Insertion Loss with Connectors *	dB	< 1.4
Back Reflection	dB	< -55
Back Reflection with SC/UPC *	dB	< -50
Crosstalk	dB	< -70
Polarization Dependent Loss	dB	< 0.08
Repeatability	dB	< ± 0.02
Switching Time	ms	< 200
Durability	cycle	> 1 million
Input Optical Power	mW	< 300
Control	--	Ethernet RJ-45 on front panel
Operating Voltage	V AC	90 ~ 240 VAC, 50/60 Hz
Power Consumption	W	< 10
Operating Temperature	°C	0 to 50
Storage Temperature	°C	-40 to 70
Humidity	--	<95% RH, Non-Condensing
Fiber Type	--	Corning SMF-28 (9/125 μm)
Optical I/O Connectors	--	SC/APC
Housing Dimensions (H x W x L)	--	1.72 x 8.37 x 6.0 inch, 1U-half 43.7 x 212.6 x 152.4 mm
Weight of Unit	kg	1.8

\*Specifications with connectors are for incoming inspection only.



OPTOWAVES, INC. PTTIC SWITCH

## LT-3000 2x8 Synchronous Fiber Optic Switch

### Switch Configuration

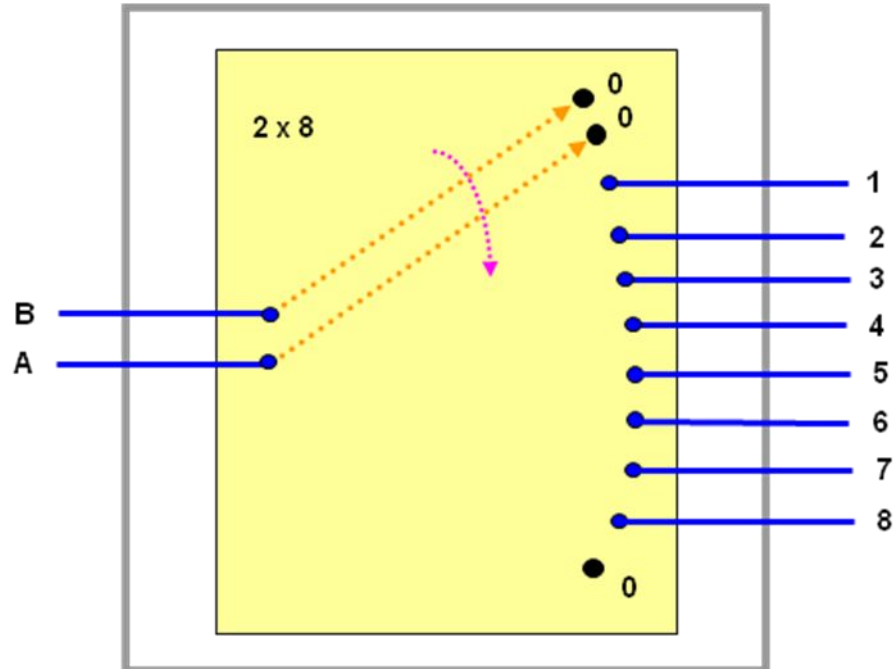

### Switch Command

Command	Optical Paths
switch 0	(A, B) to (0, 0)
switch 1	(A, B) to (1, 0)
switch 2	(A, B) to (2, 1)
switch 3	(A, B) to (3, 2)
switch 4	(A, B) to (4, 3)
switch 5	(A, B) to (5, 4)
switch 6	(A, B) to (6, 5)
switch 7	(A, B) to (7, 6)
switch 8	(A, B) to (8, 7)
switch 9	(A, B) to (0, 8)

# LT-3000 2x8 Synchronous Fiber Optic Switch

## Panel Layout

Front Panel:

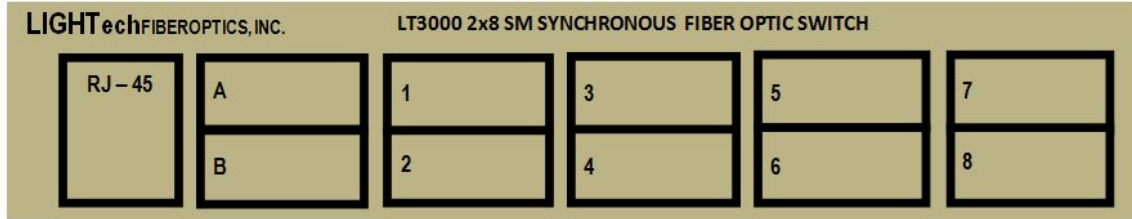

Rear Panel:

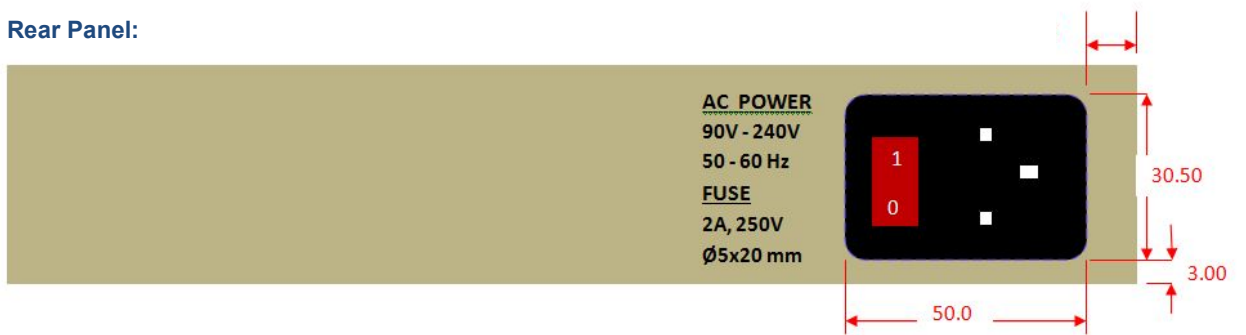

## Overall Size

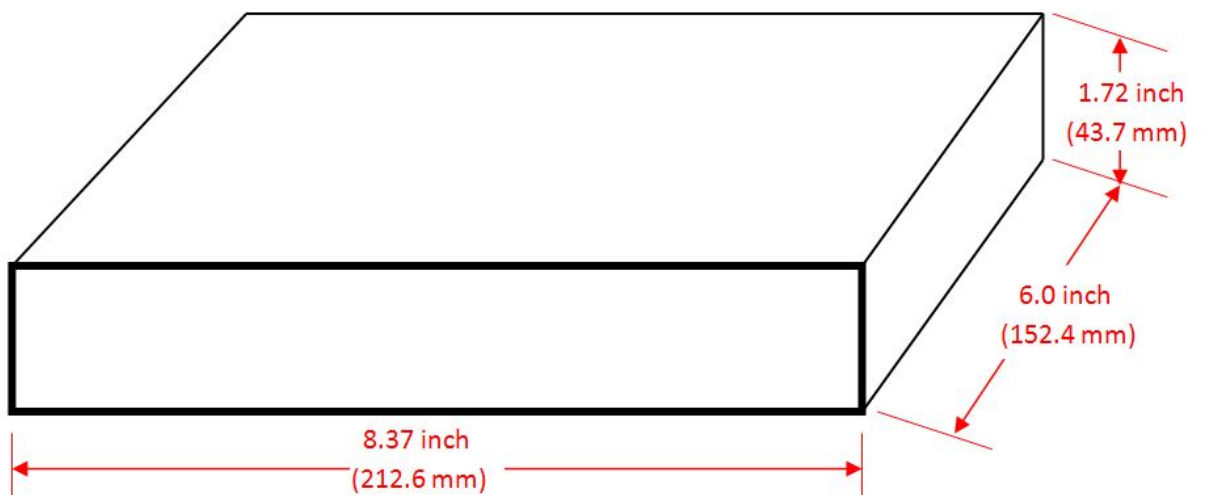

LT-3000 2x8 Synchronous Fiber Optic Switch

Control Commands

Command Format	Description	Example		Note
		Command	Response	
*IDN?↵	<b>Instrument identification query</b> <b>Response:</b> m Vx↵ m: model number x: firmware version	*IDN?↵	LT3000 V1.6.8↵	Model No.: LT3000 Firmware Version: 1.6.8
*OPC?↵	<b>Completion of commands</b> <b>Response:</b> 1↵	*OPC?↵	1↵	All received commands have completed. Output buffer is clear.
*RST↵	<b>Reset system command.</b> <b>Switch port A to off position (0) and execute internal test.</b> <b>Response:</b> 0,OK↵ internal test passed ERR3↵ internal test failed	*RST↵	0,OK↵	Internal test passed
switch #↵	<b>Switch port A to channel #, where # = 0 ~ 9</b> <b>Response:</b> n,OK↵ where n = 00 ~ 09 ERR2↵ if # > 9	switch 4↵	04,OK↵	Switch A to channel 4
switch? ↵	<b>Queries port A position</b> <b>Response:</b> n↵ where n = 0 ~ 9	switch? ↵	4↵	A is at channel 4

↵ : ASCII character 13 (hex D)



OPTOWAVES, INC. P T T I C S W I T C H